

# TOSHIBA OWNER MANUAL

## Toshiba Home AC Control

Please visit the application store on your device to download and install Toshiba Home AC Control application.



Application

Keyword : Toshiba Home AC Control

## Toshiba Home AC Control application support.



iOS : 9.0 or later.



Android : Version 5.0 or later.

## About Toshiba Home AC Control.

1. Toshiba Home AC Control can control A/C operation by Smartphone or tablet (mobile device) via internet connection.
2. Everywhere control, control software run on Cloud system and mobile device can set and monitor A/C operation via internet connection.
3. Customer can control, 1 adapter maximum 5 Users (use 1 email to register).
4. Multi A/C system control, 1 user can control 10 A/C.
5. Group control.
  - 5.1 Customer can create and control 3 groups of A/C.
  - 5.2 Customer can control max 10 A/C per group.

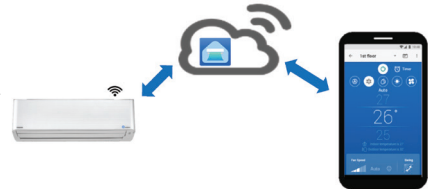

## Note :

1. Adapter can register only 1 email address, if register with new email, current email will be invalid.
2. 1 email address can be used with register for 5 mobile devices for control same A/C.

## Registration process.

Open an application and follow register for User registration.

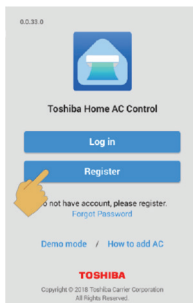

① Tab Register

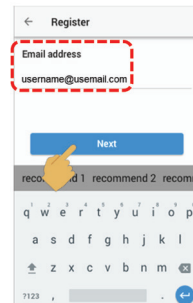

② Enter email address

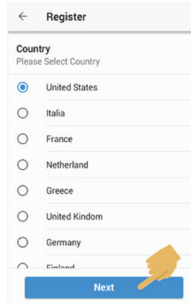

③ Select country

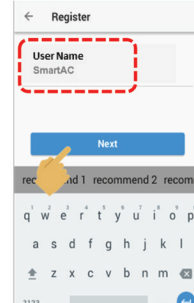

④ Enter user name

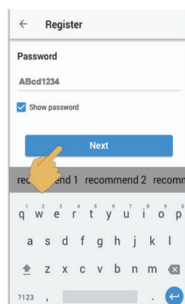

⑤ Enter password by 6-10 characters, combination of alphabet and number

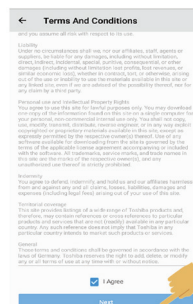

⑥ Check for terms and conditions

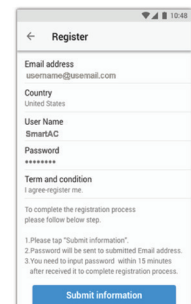

⑦ Confirm information



⑧ Information will be submitted to email, click link to confirm

**Login to Toshiba Home AC Control application.**

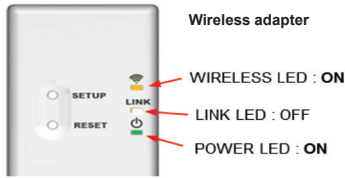

\*Note

1. In case of Wi-Fi router change or Email for register change need to re-process for add Wireless adapter again (need to press SETUP button 1 time for active AP mode).
2. In case of change Wireless adapter to use with other A/C need to factory reset (press and hold SETUP 5s) and re-process for add Wireless adapter again.

① Connect Wireless adapter to A/C and turn on power supply.

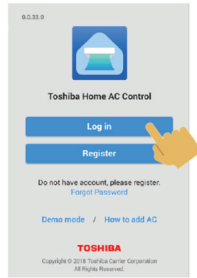

② Open application and select Log in.

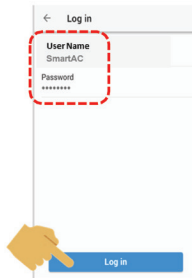

③ Enter user name and password.

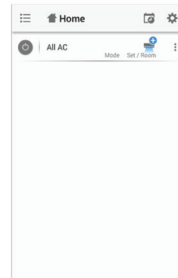

④ Login successful.

**Add Wireless adapter for control by Toshiba Home AC Control application.**



① At Home screen select "Add AC (Adapter)".

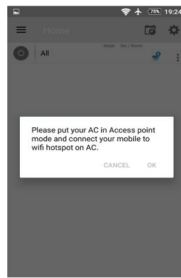

② Pop-up will show about setting condition.

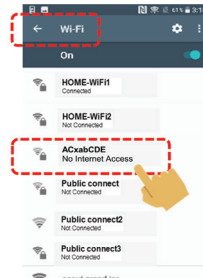

③ Swap from Application to SETTING of your device and enter Wi-Fi setting, select Wireless adapter name start from "ACxxxxxx".

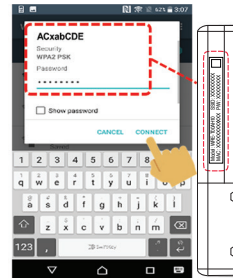

④ Input SSID and password of Wireless adapter.

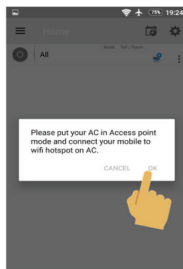

⑤ Swap to Application and select OK.

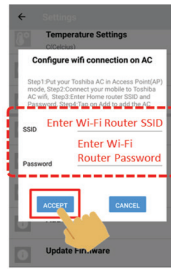

⑥ Swap to application and input Home Wi-Fi SSID and password.



⑦ A/C add finished.



**Toshiba Home AC Control application.**  
**Home screen**

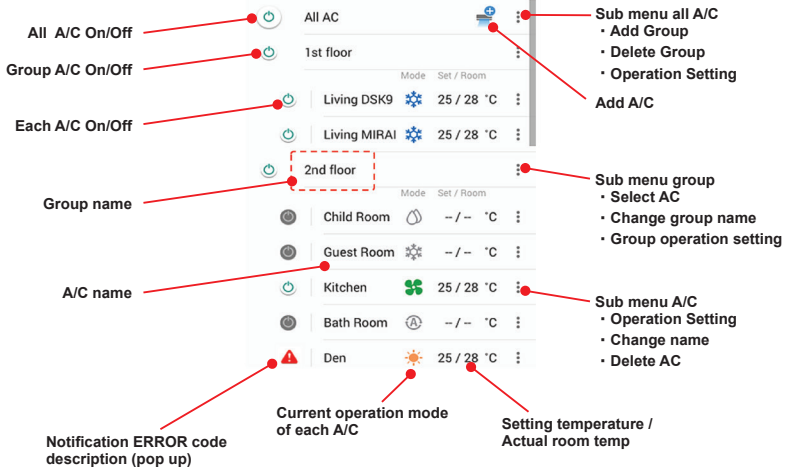
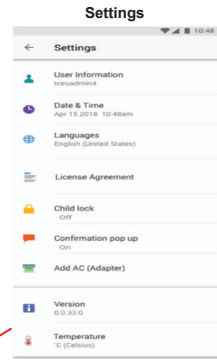
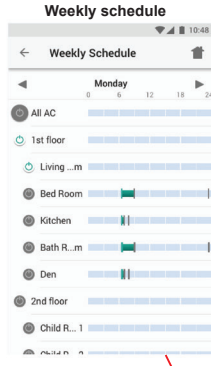
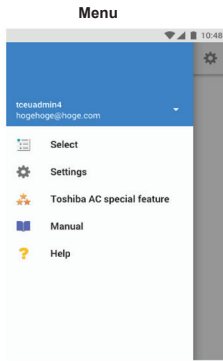
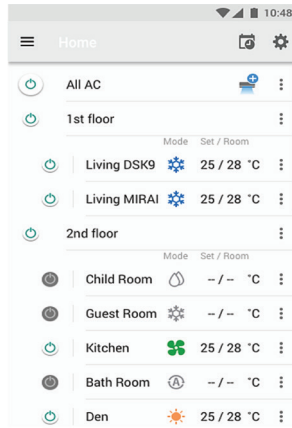

**Mode and Condition setting.**

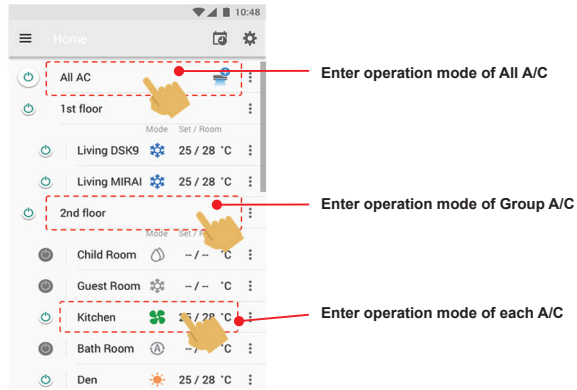

**Mode select for Toshiba Home AC Control application.**

Provide for 5 operation modes



**Setting in operation mode.**

**Tab for select A/C**

**Weekly schedule**

**Mode select**

**OFF-ON Timer set**

**Temperature set**

**Indoor temperature**

**Outdoor temperature**

**OFF-ON timer set 0.5-12hrs.**

**Off Timer**  
Please Select hour

- 0.5
- 1.0
- 1.5
- 2.0
- 2.5
- 3.0
- 9.6

**On Timer**  
Please Select hour

- 0.5
- 1.0
- 1.5
- 2.0
- 2.5
- 3.0
- 9.6

**ON timer set from**

**Fan speed and louver set**

**Special feature**

**OFF mode**

**LED wireless adapter and A/C ON/OFF control.**

**Room name**

**Wireless adapter**

Adapter version  
1.00.02

LED Wireless adapter  
LED AC + Adapter

**Select On/Off**

SETUP LINK

RESET

**Group operation.**

Maximum 3 groups

1 Group maximum = 10 units.

**Add group**

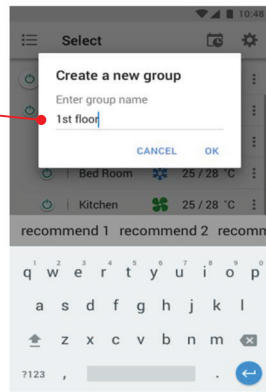
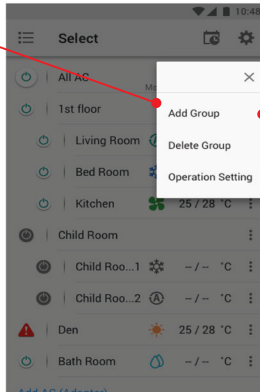
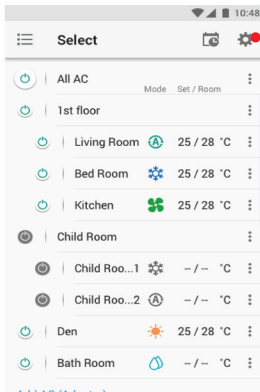

**Select A/C in group**

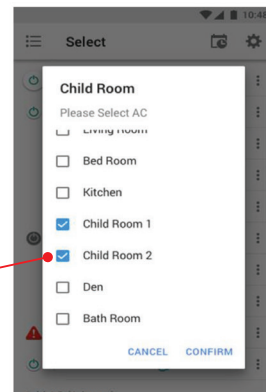
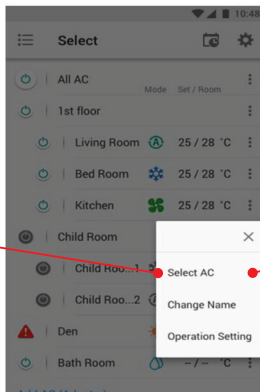
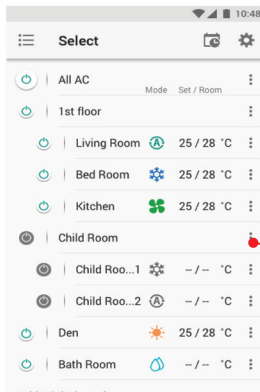

**Delete A/C**

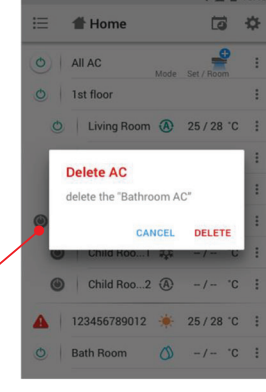
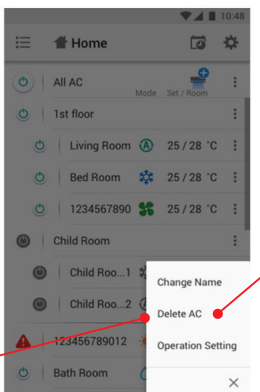
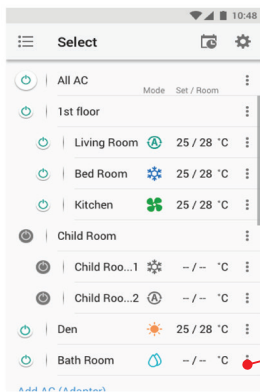

**Weekly schedule set.**

**Day select**  
Monday - Sunday

**Weekly schedule of all A/C unit**

**Weekly schedule of all A/C unit**

**Weekly schedule set for each unit**

**Time select**

**Mode select**

Select program for active by tick at select box

#### Weekly schedule cancel.

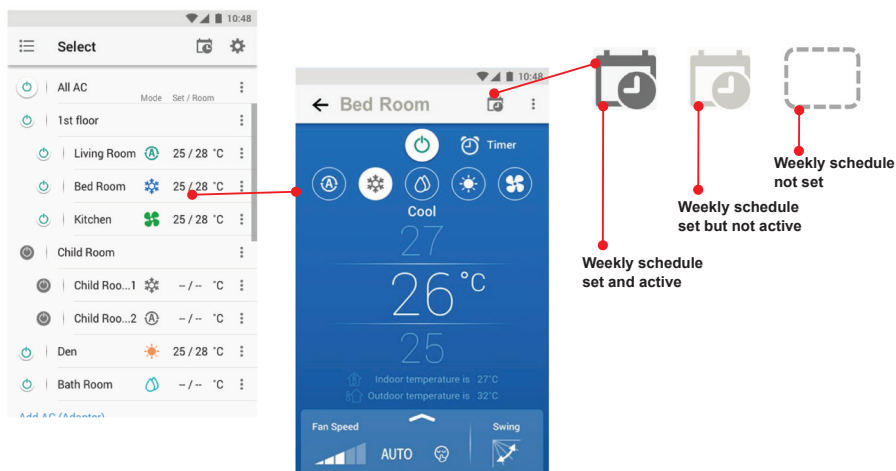

#### **Note :**

“Contact dealer and/or service center when equipment is malfunction.”

“Neem contact op met de dealer en/of het servicecentrum wanneer de apparatuur niet goed werkt.”

«Επικοινωνήστε με τον αντιπρόσωπο ή/και το κέντρο σέρβις σε περίπτωση δυσλειτουργίας του εξοπλισμού.»

“Contattare il rivenditore e/o il centro di assistenza quando l'apparecchiatura non funziona correttamente.”

“Póngase en contacto con el distribuidor y/o el centro de servicio cuando el equipo no funciona bien.”

“Jos laitteessa ilmenee vikaa, ota yhteyttä jälleenmyyjään ja/tai huoltoliikkeeseen.”

«En cas de dysfonctionnement de l'équipement, veuillez contacter le revendeur et/ou le centre de service.»

“Wenden Sie sich an den Händler und/oder das Servicezentrum, wenn das Gerät nicht funktioniert.”

“Kontakt forhandler og/eller servicesenter når det oppstår feil på utstyret.”